

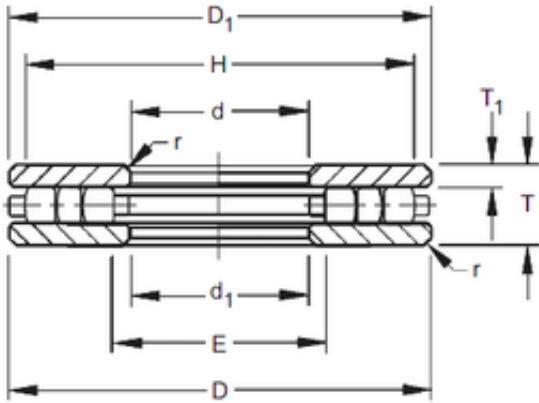

Timken 120TP153 Thrust Cylindrical Roller Bearing

Bearing No. 120TP153



120TP153 Bearing 2D drawings and 3D CAD models

Size	304.8x609.6x114.3 mm
Bore Diameter	304,8 mm
Outer Diameter	609,6 mm
Width	114,3 mm
d	304,8 mm
D	609,6 mm
T	114,3 mm
r max	6,4 mm
T1	31,75 mm
d1	307,18 mm
D1	607,22 mm
E	330,2 mm
H	584,2 mm