

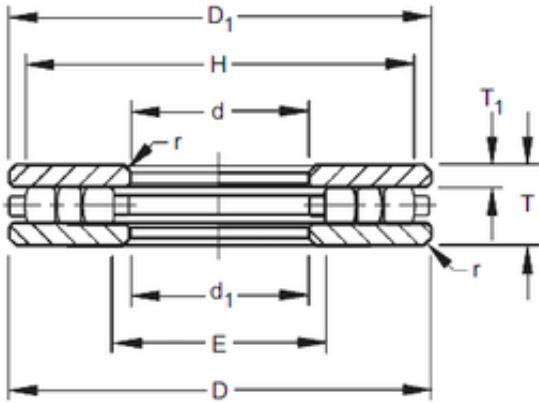

Timken 50TP122 Thrust Cylindrical Roller Bearing

Bearing No. 50TP122



50TP122 Bearing 2D drawings and 3D CAD models

Size	127x279.4x50.8 mm
Bore Diameter	127 mm
Outer Diameter	279,4 mm
Width	50,8 mm
d	127 mm
D	279,4 mm
T	50,8 mm
r max	3,2 mm
T1	14,29 mm
d1	128,59 mm
D1	277,81 mm
E	144,5 mm
H	261,9 mm