

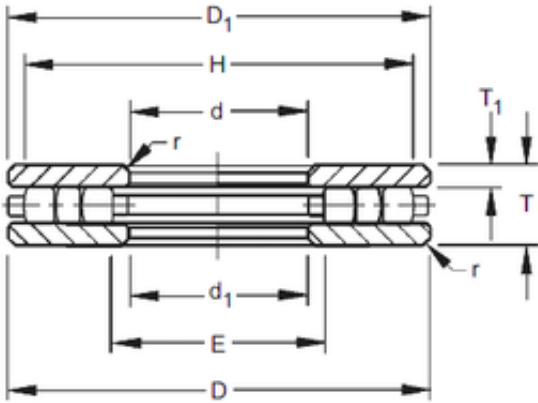

Timken 35TP113 Thrust Cylindrical Roller Bearing

Bearing No. 35TP113



35TP113 Bearing 2D drawings and 3D CAD models

Size	88.9x132.558x25.4 mm
Bore Diameter	88,9 mm
Outer Diameter	132,558 mm
Width	25,4 mm
d	88,9 mm
D	132,558 mm
T	25,4 mm
r max	1,6 mm
T1	7,14 mm
d1	90,49 mm
D1	130,97 mm
E	97,6 mm
H	123,8 mm