

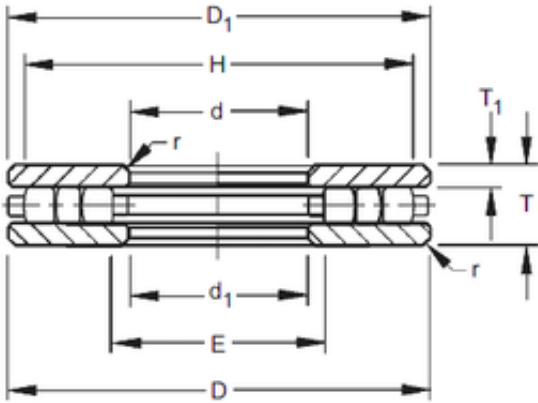

Timken 30TP108 Thrust Cylindrical Roller Bearing

Bearing No. 30TP108



30TP108 Bearing 2D drawings and 3D CAD models

Size	76.2x203.2x34.925 mm
Bore Diameter	76,2 mm
Outer Diameter	203,2 mm
Width	34,925 mm
d	76,2 mm
D	203,2 mm
T	34,925 mm
r max	1,6 mm
T1	9,52 mm
d1	77,79 mm
D1	201,61 mm
E	90,5 mm
H	188,9 mm