

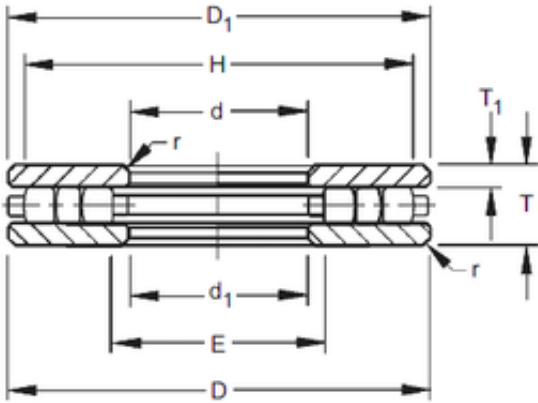

Timken 30TP106 Thrust Cylindrical Roller Bearing

Bearing No. 30TP106



30TP106 Bearing 2D drawings and 3D CAD models

Size	76.2x152.4x34.925 mm
Bore Diameter	76,2 mm
Outer Diameter	152,4 mm
Width	34,925 mm
d	76,2 mm
D	152,4 mm
T	34,925 mm
r max	1,6 mm
T1	9,52 mm
d1	77,79 mm
D1	150,81 mm
E	85,7 mm
H	142,9 mm