

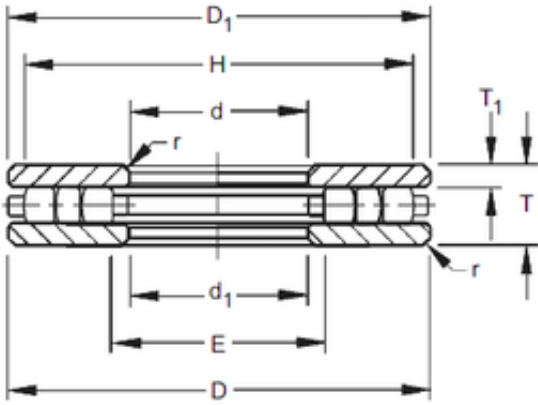

Timken 20TP104 Thrust Cylindrical Roller Bearing

Bearing No. 20TP104



20TP104 Bearing 2D drawings and 3D CAD models

Size	50.8x177.8x34.925 mm
Bore Diameter	50,8 mm
Outer Diameter	177,8 mm
Width	34,925 mm
d	50,8 mm
D	177,8 mm
T	34,925 mm
r max	1,6 mm
T1	9,52 mm
d1	52,39 mm
D1	176,21 mm
E	65,1 mm
H	163,5 mm